

* required information

Section 1 of 21

You can save the form at any time and resume it later. You do not need to be logged in when you resume.

- System reference This is the unique reference for this application generated by the system.
- Your reference You can put what you want here to help you track applications if you make lots of them. It is passed to the authority.
- Are you an agent acting on behalf of the applicant? Put "no" if you are applying on your own behalf or on behalf of a business you own or work for.
- Yes No

Applicant Details

- * First name
- * Family name
- * E-mail
- Main telephone number Include country code.
- Other telephone number
- Indicate here if the applicant would prefer not to be contacted by telephone

Is the applicant:

- Applying as a business or organisation, including as a sole trader
- Applying as an individual
- A sole trader is a business owned by one person without any special legal structure. Applying as an individual means the applicant is applying so the applicant can be employed, or for some other personal reason, such as following a hobby.

Applicant Business

- Is the applicant's business registered in the UK with Companies House? Yes No
- Registration number
- Business name If the applicant's business is registered, use its registered name.
- VAT number Put "none" if the applicant is not registered for VAT.
- Legal status

Continued from previous page...

Applicant's position in the business

Home country

The country where the applicant's headquarters are.

Registered Address

Address registered with Companies House.

Building number or name

Street

District

City or town

County or administrative area

Postcode

Country

Agent Details

* First name

* Family name

* E-mail

Main telephone number

Include country code.

Other telephone number

Indicate here if you would prefer not to be contacted by telephone

Are you:

- An agent that is a business or organisation, including a sole trader
- A private individual acting as an agent

A sole trader is a business owned by one person without any special legal structure.

Agent Business

Is your business registered in the UK with Companies House? Yes No

Note: completing the Applicant Business section is optional in this form.

Is your business registered outside the UK? Yes No

Business name

If your business is registered, use its registered name.

VAT number

Put "none" if you are not registered for VAT.

Legal status

Continued from previous page...

Your position in the business

Home country

The country where the headquarters of your business is located.

Agent Business Address

If you have one, this should be your official address - that is an address required of you by law for receiving communications.

Building number or name

Street

District

City or town

County or administrative area

Postcode

Country

Section 2 of 21

PREMISES DETAILS

I/we, as named in section 1, apply for a premises licence under section 17 of the Licensing Act 2003 for the premises described in section 2 below (the premises) and I/we are making this application to you as the relevant licensing authority in accordance with section 12 of the Licensing Act 2003.

Premises Address

Are you able to provide a postal address, OS map reference or description of the premises?

- Address OS map reference Description

Postal Address Of Premises

Building number or name

Street

District

City or town

County or administrative area

Postcode

Country

Further Details

Telephone number

Non-domestic rateable value of premises (£)

Section 3 of 21

APPLICATION DETAILS

In what capacity are you applying for the premises licence?

- An individual or individuals
- A limited company / limited liability partnership
- A partnership (other than limited liability)
- An unincorporated association
- Other (for example a statutory corporation)
- A recognised club
- A charity
- The proprietor of an educational establishment
- A health service body
- A person who is registered under part 2 of the Care Standards Act 2000 (c14) in respect of an independent hospital in Wales
- A person who is registered under Chapter 2 of Part 1 of the Health and Social Care Act 2008 in respect of the carrying on of a regulated activity (within the meaning of that Part) in an independent hospital in England
- The chief officer of police of a police force in England and Wales

Confirm The Following

- I am carrying on or proposing to carry on a business which involves the use of the premises for licensable activities
- I am making the application pursuant to a statutory function
- I am making the application pursuant to a function discharged by virtue of His Majesty's prerogative

Section 4 of 21

NON INDIVIDUAL APPLICANTS

Provide name and registered address of applicant in full. Where appropriate give any registered number. In the case of a partnership or other joint venture (other than a body corporate), give the name and address of each party concerned.

Non Individual Applicant's Name

Name

Details

Registered number (where applicable)

Description of applicant (for example partnership, company, unincorporated association etc)

Continued from previous page...

company

Address

Building number or name

Street

District

City or town

County or administrative area

Postcode

Country

Contact Details

E-mail

Telephone number

Other telephone number

* Date of birth / /
dd mm yyyy

* Nationality [Documents that demonstrate entitlement to work in the UK](#)

Add another applicant

Section 5 of 21

OPERATING SCHEDULE

When do you want the premises licence to start? / /
dd mm yyyy

If you wish the licence to be valid only for a limited period, when do you want it to end / /
dd mm yyyy

Provide a general description of the premises

For example the type of premises, its general situation and layout and any other information which could be relevant to the licensing objectives. Where your application includes off-supplies of alcohol and you intend to provide a place for consumption of these off- supplies you must include a description of where the place will be and its proximity to the premises.

Ground floor Riverside Stand. Main concourse area providing food and drink to anyone attending the stadium, including passers by from Riverside Walk

Continued from previous page...

If 5,000 or more people are expected to attend the premises at any one time, state the number expected to attend

Section 6 of 21

PROVISION OF PLAYS

[See guidance on regulated entertainment](#)

Will you be providing plays?

- Yes No

Section 7 of 21

PROVISION OF FILMS

[See guidance on regulated entertainment](#)

Will you be providing films?

- Yes No

Section 8 of 21

PROVISION OF INDOOR SPORTING EVENTS

[See guidance on regulated entertainment](#)

Will you be providing indoor sporting events?

- Yes No

Section 9 of 21

PROVISION OF BOXING OR WRESTLING ENTERTAINMENTS

[See guidance on regulated entertainment](#)

Will you be providing boxing or wrestling entertainments?

- Yes No

Section 10 of 21

PROVISION OF LIVE MUSIC

[See guidance on regulated entertainment](#)

Will you be providing live music?

- Yes No

Section 11 of 21

PROVISION OF RECORDED MUSIC

[See guidance on regulated entertainment](#)

Will you be providing recorded music?

- Yes No

Section 12 of 21

PROVISION OF PERFORMANCES OF DANCE

[See guidance on regulated entertainment](#)

Will you be providing performances of dance?

Continued from previous page...

Section 13 of 21

PROVISION OF ANYTHING OF A SIMILAR DESCRIPTION TO LIVE MUSIC, RECORDED MUSIC OR PERFORMANCES OF DANCE

[See guidance on regulated entertainment](#)

Will you be providing anything similar to live music, recorded music or performances of dance?

- Yes No

Section 14 of 21

LATE NIGHT REFRESHMENT

Will you be providing late night refreshment?

- Yes No

Section 15 of 21

SUPPLY OF ALCOHOL

Will you be selling or supplying alcohol?

- Yes No

Standard Days And Timings

MONDAY

Start

End

Start

End

Give timings in 24 hour clock.
(e.g., 16:00) and only give details for the days
of the week when you intend the premises
to be used for the activity.

TUESDAY

Start

End

Start

End

WEDNESDAY

Start

End

Start

End

THURSDAY

Start

End

Start

End

FRIDAY

Start

End

Start

End

SATURDAY

Start

End

Start

End

Continued from previous page...

SUNDAY

Start

End

Start

End

Will the sale of alcohol be for consumption:

- On the premises Off the premises Both

If the sale of alcohol is for consumption on the premises select on, if the sale of alcohol is for consumption away from the premises select off. If the sale of alcohol is for consumption on the premises and away from the premises select both.

State any seasonal variations

For example (but not exclusively) where the activity will occur on additional days during the summer months.

Non-standard timings. Where the premises will be used for the supply of alcohol at different times from those listed in the column on the left, list below

For example (but not exclusively), where you wish the activity to go on longer on a particular day e.g. Christmas Eve.

State the name and details of the individual whom you wish to specify on the licence as premises supervisor

Name

First name

Family name

Date of birth / /

Continued from previous page...

Enter the contact's address

Building number or name	<input type="text"/>
Street	<input type="text"/>
District	<input type="text"/>
City or town	<input type="text"/>
County or administrative area	<input type="text"/>
Postcode	<input type="text"/>
Country	<input type="text" value="United Kingdom"/>
Personal Licence number (if known)	<input type="text" value="09/00816/LIPERS"/>
Issuing licensing authority (if known)	<input type="text" value="Croydon"/>

PROPOSED DESIGNATED PREMISES SUPERVISOR CONSENT

How will the consent form of the proposed designated premises supervisor be supplied to the authority?

- Electronically, by the proposed designated premises supervisor
- As an attachment to this application

Reference number for consent form (if known)

If the consent form is already submitted, ask the proposed designated premises supervisor for its 'system reference' or 'your reference'.

Section 16 of 21

ADULT ENTERTAINMENT

Highlight any adult entertainment or services, activities, or other entertainment or matters ancillary to the use of the premises that may give rise to concern in respect of children

Give information about anything intended to occur at the premises or ancillary to the use of the premises which may give rise to concern in respect of children, regardless of whether you intend children to have access to the premises, for example (but not exclusively) nudity or semi-nudity, films for restricted age groups etc gambling machines etc.

Section 17 of 21

HOURS PREMISES ARE OPEN TO THE PUBLIC

Standard Days And Timings

MONDAY

Start

End

Start

End

Give timings in 24 hour clock. (e.g., 16:00) and only give details for the days of the week when you intend the premises to be used for the activity.

Continued from previous page...

TUESDAY

Start	<input type="text" value="08:00"/>	End	<input type="text" value="23:30"/>
Start	<input type="text"/>	End	<input type="text"/>

WEDNESDAY

Start	<input type="text" value="08:00"/>	End	<input type="text" value="23:30"/>
Start	<input type="text"/>	End	<input type="text"/>

THURSDAY

Start	<input type="text" value="08:00"/>	End	<input type="text" value="23:30"/>
Start	<input type="text"/>	End	<input type="text"/>

FRIDAY

Start	<input type="text" value="08:00"/>	End	<input type="text" value="23:30"/>
Start	<input type="text"/>	End	<input type="text"/>

SATURDAY

Start	<input type="text" value="08:00"/>	End	<input type="text" value="23:30"/>
Start	<input type="text"/>	End	<input type="text"/>

SUNDAY

Start	<input type="text" value="08:00"/>	End	<input type="text" value="23:30"/>
Start	<input type="text"/>	End	<input type="text"/>

State any seasonal variations

For example (but not exclusively) where the activity will occur on additional days during the summer months.

Non standard timings. Where you intend to use the premises to be open to the members and guests at different times from those listed in the column on the left, list below

For example (but not exclusively), where you wish the activity to go on longer on a particular day e.g. Christmas Eve.

Section 18 of 21

LICENSING OBJECTIVES

Describe the steps you intend to take to promote the four licensing objectives:

a) General – all four licensing objectives (b,c,d,e)

Continued from previous page...

List here steps you will take to promote all four licensing objectives together.

See attached schedule of conditions

b) The prevention of crime and disorder

see box a

c) Public safety

see box a

d) The prevention of public nuisance

see box a

e) The protection of children from harm

see box a

Section 19 of 21

NOTES ON DEMONSTRATING ENTITLEMENT TO WORK IN THE UK

Continued from previous page...

Entitlement to work/immigration status for individual applicants and applications from partnerships which are not limited liability partnerships:

A licence may not be held by an individual or an individual in a partnership who is resident in the UK who:

- does not have the right to live and work in the UK; or
- is subject to a condition preventing him or her from doing work relating to the carrying on of a licensable activity.

Any premises licence issued in respect of an application made on or after 6 April 2017 will become invalid if the holder ceases to be entitled to work in the UK.

Applicants must demonstrate that they have an entitlement to work in the UK and are not subject to a condition preventing them from doing work relating to the carrying on of a licensable activity. They do this in one of two ways: 1) by providing with this application copies or scanned copies of the documents listed below (which do not need to be certified), or 2) by providing their 'share code' to enable the licensing authority to carry out a check using the Home Office online right to work checking service (see below).

Documents which demonstrate entitlement to work in the UK

- An expired or current passport showing the holder, or a person named in the passport as the child of the holder, is a British citizen or a citizen of the UK and Colonies having the right of abode in the UK [please see note below about which sections of the passport to copy].
- An expired or current passport or national identity card showing the holder, or a person named in the passport as the child of the holder, is a national of a European Economic Area country or Switzerland.
- A Registration Certificate or document certifying permanent residence issued by the Home Office to a national of a European Economic Area country or Switzerland.
- A Permanent Residence Card issued by the Home Office to the family member of a national of a European Economic Area country or Switzerland.
- A **current** Biometric Immigration Document (Biometric Residence Permit) issued by the Home Office to the holder indicating that the person named is allowed to stay indefinitely in the UK, or has no time limit on their stay in the UK.
- A **current** passport endorsed to show that the holder is exempt from immigration control, is allowed to stay indefinitely in the UK, has the right of abode in the UK, or has no time limit on their stay in the UK.
- A **current** Immigration Status Document issued by the Home Office to the holder with an endorsement indicating that the named person is allowed to stay indefinitely in the UK or has no time limit on their stay in the UK, **when produced in combination with** an official document giving the person's permanent National Insurance number and their name issued by a Government agency or a previous employer.
- A birth or adoption certificate issued in the UK, **when produced in combination with** an official document giving the person's permanent National Insurance number and their name issued by a Government agency or a previous employer.
- A birth or adoption certificate issued in the Channel Islands, the Isle of Man or Ireland **when produced in combination with** an official document giving the person's permanent National Insurance number and their name issued by a Government agency or a previous employer.
- A certificate of registration or naturalisation as a British citizen, **when produced in combination with** an official document giving the person's permanent National Insurance number and their name issued by a Government agency or a previous employer.

Continued from previous page...

- A **current** passport endorsed to show that the holder is allowed to stay in the UK and is currently allowed to work and is not subject to a condition preventing the holder from doing work relating to the carrying on of a licensable activity.
- A **current** Biometric Immigration Document (Biometric Residence Permit) issued by the Home Office to the holder which indicates that the named person can currently stay in the UK and is allowed to work relation to the carrying on of a licensable activity.
- A **current** Residence Card issued by the Home Office to a person who is not a national of a European Economic Area state or Switzerland but who is a family member of such a national or who has derivative rights or residence.
- A **current** Immigration Status Document containing a photograph issued by the Home Office to the holder with an endorsement indicating that the named person may stay in the UK, and is allowed to work and is not subject to a condition preventing the holder from doing work relating to the carrying on of a licensable activity **when produced in combination with** an official document giving the person's permanent National Insurance number and their name issued by a Government agency or a previous employer.
- A Certificate of Application, **less than 6 months old**, issued by the Home Office under regulation 18(3) or 20(2) of the Immigration (European Economic Area) Regulations 2016, to a person who is not a national of a European Economic Area state or Switzerland but who is a family member of such a national or who has derivative rights of residence.
- Reasonable evidence that the person has an outstanding application to vary their permission to be in the UK with the Home Office such as the Home Office acknowledgement letter or proof of postage evidence, or reasonable evidence that the person has an appeal or administrative review pending on an immigration decision, such as an appeal or administrative review reference number.
- Reasonable evidence that a person who is not a national of a European Economic Area state or Switzerland but who is a family member of such a national or who has derivative rights of residence in exercising treaty rights in the UK including:-
 - evidence of the applicant's own identity – such as a passport,
 - evidence of their relationship with the European Economic Area family member – e.g. a marriage certificate, civil partnership certificate or birth certificate, and
 - evidence that the European Economic Area national has a right of permanent residence in the UK or is one of the following if they have been in the UK for more than 3 months:
 - (i) working e.g. employment contract, wage slips, letter from the employer,
 - (ii) self-employed e.g. contracts, invoices, or audited accounts with a bank,
 - (iii) studying e.g. letter from the school, college or university and evidence of sufficient funds; or
 - (iv) self-sufficient e.g. bank statements.

Family members of European Economic Area nationals who are studying or financially independent must also provide evidence that the European Economic Area national and any family members hold comprehensive sickness insurance in the UK. This can include a private medical insurance policy, an EHIC card or an S1, S2 or S3 form.

Original documents must not be sent to licensing authorities. If the document copied is a passport, a copy of the following pages should be provided:-

- (i) any page containing the holder's personal details including nationality;
- (ii) any page containing the holder's photograph;
- (iii) any page containing the holder's signature;
- (iv) any page containing the date of expiry; and
- (v) any page containing information indicating the holder has permission to enter or remain in the UK and is permitted to work.

Continued from previous page...

If the document is not a passport, a copy of the whole document should be provided.

Your right to work will be checked as part of your licensing application and this could involve us checking your immigration status with the Home Office. We may otherwise share information with the Home Office. Your licence application will not be determined until you have complied with this guidance.

Home Office online right to work checking service

As an alternative to providing a copy of the documents listed above, applicants may demonstrate their right to work by allowing the licensing authority to carry out a check with the Home Office online right to work checking service.

To demonstrate their right to work via the Home Office online right to work checking service, applicants should include in this application their 9-digit share code (provided to them upon accessing the service at <https://www.gov.uk/prove-right-to-work>) which, along with the applicant's date of birth (provided within this application), will allow the licensing authority to carry out the check.

In order to establish the applicant's right to work, the check will need to indicate that the applicant is allowed to work in the United Kingdom and is not subject to a condition preventing them from doing work relating to the carrying on of a licensable activity.

An online check will not be possible in all circumstances because not all applicants will have an immigration status that can be checked online. The Home Office online right to work checking service sets out what information and/or documentation applicants will need in order to access the service. Applicants who are unable to obtain a share code from the service should submit copy documents as set out above.

Section 20 of 21

NOTES ON REGULATED ENTERTAINMENT

Continued from previous page...

In terms of specific **regulated entertainments** please note that:

- Plays: no licence is required for performances between 08:00 and 23.00 on any day, provided that the audience does not exceed 500.
- Films: no licence is required for 'not-for-profit' film exhibition held in community premises between 08.00 and 23.00 on any day provided that the audience does not exceed 500 and the organiser (a) gets consent to the screening from a person who is responsible for the premises; and (b) ensures that each such screening abides by age classification ratings.
- Indoor sporting events: no licence is required for performances between 08.00 and 23.00 on any day, provided that the audience does not exceed 1000.
- Boxing or Wrestling Entertainment: no licence is required for a contest, exhibition or display of Greco-Roman wrestling, or freestyle wrestling between 08.00 and 23.00 on any day, provided that the audience does not exceed 1000. Combined fighting sports – defined as a contest, exhibition or display which combines boxing or wrestling with one or more martial arts – are licensable as a boxing or wrestling entertainment rather than an indoor sporting event.
- Live music: no licence permission is required for:
 - o a performance of unamplified live music between 08.00 and 23.00 on any day, on any premises.
 - o a performance of amplified live music between 08.00 and 23.00 on any day on premises authorised to sell alcohol for consumption on those premises, provided that the audience does not exceed 500.
 - o a performance of amplified live music between 08.00 and 23.00 on any day, in a workplace that is not licensed to sell alcohol on those premises, provided that the audience does not exceed 500.
 - o a performance of amplified live music between 08.00 and 23.00 on any day, in a church hall, village hall, community hall, or other similar community premises, that is not licensed by a premises licence to sell alcohol, provided that (a) the audience does not exceed 500, and (b) the organiser gets consent for the performance from a person who is responsible for the premises.
 - o a performance of amplified live music between 08.00 and 23.00 on any day, at the non-residential premises of (i) a local authority, or (ii) a school, or (iii) a hospital, provided that (a) the audience does not exceed 500, and (b) the organiser gets consent for the performance on the relevant premises from: (i) the local authority concerned, or (ii) the school or (iii) the health care provider for the hospital.
- Recorded Music: no licence permission is required for:
 - o any playing of recorded music between 08.00 and 23.00 on any day on premises authorised to sell alcohol for consumption on those premises, provided that the audience does not exceed 500.
 - o any playing of recorded music between 08.00 and 23.00 on any day, in a church hall, village hall, community hall, or other similar community premises, that is not licensed by a premises licence to sell alcohol, provided that (a) the audience does not exceed 500, and (b) the organiser gets consent for the performance from a person who is responsible for the premises.
 - o any playing of recorded music between 08.00 and 23.00 on any day, at the non-residential premises of (i) a local authority, or (ii) a school, or (iii) a hospital, provided that (a) the audience does not exceed 500, and (b) the organiser gets consent for the performance on the relevant premises from: (i) the local authority concerned, or (ii) the school proprietor or (iii) the health care provider for the hospital.

Continued from previous page...

- Dance: no licence is required for performances between 08.00 and 23.00 on any day, provided that the audience does not exceed 500. However, a performance which amounts to adult entertainment remains licensable.
- Cross activity exemptions: no licence is required between 08.00 and 23.00 on any day, with no limit on audience size for:
 - o any entertainment taking place on the premises of the local authority where the entertainment is provided by or on behalf of the local authority;
 - o any entertainment taking place on the hospital premises of the health care provider where the entertainment is provided by or on behalf of the health care provider;
 - o any entertainment taking place on the premises of the school where the entertainment is provided by or on behalf of the school proprietor; and
 - o any entertainment (excluding films and a boxing or wrestling entertainment) taking place at a travelling circus, provided that (a) it takes place within a moveable structure that accommodates the audience, and (b) that the travelling circus has not been located on the same site for more than 28 consecutive days.

Section 21 of 21

PAYMENT DETAILS

This fee must be paid to the authority. If you complete the application online, you must pay it by debit or credit card.

Premises Licence Fees are determined by the non domestic rateable value of the premises.

To find out a premises non domestic rateable value go to the Valuation Office Agency site at http://www.voa.gov.uk/business_rates/index.htm

Band A - No RV to £4300 £100.00

Band B - £4301 to £33000 £190.00

Band C - £33001 to £8700 £315.00

Band D - £87001 to £12500 £450.00*

Band E - £125001 and over £635.00*

*If the premises rateable value is in Bands D or E and the premises is primarily used for the consumption of alcohol on the premises then your are required to pay a higher fee

Band D - £87001 to £12500 £900.00

Band E - £125001 and over £1,905.00

There is an exemption from the payment of fees in relation to the provision of regulated entertainment at church halls, chapel halls or premises of a similar nature, village halls, parish or community halls, or other premises of a similar nature. The costs associated with these licences will be met by central Government. If, however, the licence also authorises the use of the premises for the supply of alcohol or the provision of late night refreshment, a fee will be required.

Schools and sixth form colleges are exempt from the fees associated with the authorisation of regulated entertainment where the entertainment is provided by and at the school or college and for the purposes of the school or college.

If you operate a large event you are subject to ADDITIONAL fees based upon the number in attendance at any one time

Capacity 5000-9999 £1,000.00

Capacity 10000 -14999 £2,000.00

Capacity 15000-19999 £4,000.00

Capacity 20000-29999 £8,000.00

Capacity 30000-39000 £16,000.00

Capacity 40000-49999 £24,000.00

Capacity 50000-59999 £32,000.00

Capacity 60000-69999 £40,000.00

Capacity 70000-79999 £48,000.00

Capacity 80000-89999 £56,000.00

Capacity 90000 and over £64,000.00

* Fee amount (£)

635.00

DECLARATION

Continued from previous page...

* I/we understand it is an offence, liable on conviction to a fine up to level 5 on the standard scale, under section 158 of the licensing act 2003, to make a false statement in or in connection with this application.

Ticking this box indicates you have read and understood the above declaration

This section should be completed by the applicant, unless you answered "Yes" to the question "Are you an agent acting on behalf of the applicant?"

* Full name

* Capacity

* Date / /
dd mm yyyy

Once you're finished you need to do the following:

1. Save this form to your computer by clicking file/save as...
2. Go back to <https://www.gov.uk/apply-for-a-licence/premises-licence/hammersmith-and-fulham/apply-1> to upload this file and continue with your application.

Don't forget to make sure you have all your supporting documentation to hand.

IT IS AN OFFENCE LIABLE TO SUMMARY CONVICTION TO A FINE OF ANY AMOUNT UNDER SECTION 158 OF THE LICENSING ACT 2003, TO MAKE A FALSE STATEMENT IN OR IN CONNECTION WITH THIS APPLICATION

IT IS AN OFFENCE UNDER SECTION 24B OF THE IMMIGRATION ACT 1971 FOR A PERSON TO WORK WHEN THEY KNOW, OR HAVE REASONABLE CAUSE TO BELIEVE, THAT THEY ARE DISQUALIFIED FROM DOING SO BY REASON OF THEIR IMMIGRATION STATUS. THOSE WHO EMPLOY AN ADULT WITHOUT LEAVE OR WHO IS SUBJECT TO CONDITIONS AS TO EMPLOYMENT WILL BE LIABLE TO A CIVIL PENALTY UNDER SECTION 15 OF THE IMMIGRATION, ASYLUM AND NATIONALITY ACT 2006 AND PURSUANT TO SECTION 21 OF THE SAME ACT, WILL BE COMMITTING AN OFFENCE WHERE THEY DO SO IN THE KNOWLEDGE, OR WITH REASONABLE CAUSE TO BELIEVE, THAT THE EMPLOYEE IS DISQUALIFIED

OFFICE USE ONLY

Applicant reference number	<input type="text"/>
Fee paid	<input type="text"/>
Payment provider reference	<input type="text"/>
ELMS Payment Reference	<input type="text"/>
Payment status	<input type="text"/>
Payment authorisation code	<input type="text"/>
Payment authorisation date	<input type="text"/>
Date and time submitted	<input type="text"/>
Approval deadline	<input type="text"/>
Error message	<input type="text"/>
Is Digitally signed	<input type="checkbox"/>

Ground floor conditions

1. The standard hours for supply of alcohol shall be applicable when there is no 'designated sporting event'*.

When a designated sporting event is taking place the following shall apply:

(a) The spectators in a room from which a designated sporting event may be directly viewed and to which the general public are not admitted shall drink alcohol up to 15 minutes before kick-off and from 15 minutes after the final whistle.

(b) Alcohol may be supplied for consumption in the concourse areas at any time during the period of a designated sporting event as defined by the Sporting Events (Control of Alcohol) etc Act 1985 provided that no person in possession of alcohol for the purposes of consuming it shall be able to access any position from which the event may be directly viewed. Screens and security personnel shall be deployed to ensure compliance with this condition.

*as defined by the Sporting Events (Control of Alcohol etc) Act 1985

2. Compliance with the General Safety Certificate issued under separate governing legislation shall be implicit and nature of the certificate shall be comprehensive enough to be relevant to the licensing objectives, and reference shall be made to that separate certificate.

3. Signs shall be prominently displayed in the outside area reminding patrons there are residents living nearby and instructing them to respect the neighbours and to conduct their behaviour accordingly.

4. Within the area edged red mobile units and/or mobile personnel may be used for the sale or supply of alcohol as well as the permanent bar counters. The sales and supplies from mobile units placed in pre-determined sites and/or by such personnel in pre-determined areas, to be agreed between premises licence holder, the licensing authority and the police. The positioning of alcohol stocks to be used in replenishment of these units/personnel shall be agreed as well.

5. High Definition CCTV shall be installed, operated and maintained, at all times that the premises are open for licensable activities or customers are on the premises and;

a) shall be checked every two weeks to ensure that the system is working properly and that the date and time are correct. A record of these checks, showing the date and name of the person checking, shall be kept and made available to the Police or authorised Council officers on request.

b) at least one camera will show a close-up of the entrance/entrances to the premises, to capture a clear, full length image of anyone entering.

c) shall cover any internal or external area of the premises where licensable activities take place.

d) recordings shall be in real time and stored for a minimum period of 30 days with date and time stamping.

e) footage shall be provided free of charge to the Police or authorised Council officer within 24 hours of a request.

f) a staff member from the premises that is conversant with the operation of the CCTV system shall be on the premises at all times. This staff member will be able to show Police or authorised officers

of the Licensing Authority recent data footage with the minimum of delay when requested. This data or footage reproduction shall be almost instantaneous.

g) Appropriate signage shall be displayed in prominent positions, informing customers they are being recorded on CCTV.

6. The Premises shall operate a dispersal policy and all staff shall be trained in its implementation.

7. All staff responsible for selling alcohol shall receive relevant training before making any unsupervised sales. The training shall include:

a) the Licensing Act 2003 in terms of the licensing objectives and offences committed under the Act;

b) the conditions of the Premises Licence;

c) the sale of age-restricted products.

d) This training will be refreshed at least every six months. Staff shall sign to confirm that they have received and understood the training. Written records of this training shall be retained and made available to the Police or authorised officers of the Licensing Authority upon request.

8. A responsible member of staff shall organise and accommodate meetings to discuss the operation of the premises with residents at least 4 times per calendar year. The meeting shall be advertised at least 14 days before its due date by letter to residents and residents' associations in the locality as well as to the Licensing Authority.

9. A daily incident log (electric or paper based) shall be kept at the Premises and made available on request to an authorised officer of the Council or the Police or the Fire Service which shall record the following:

(a) all crimes reported to the venue

(b) all ejection of patrons

(c) any complaints received

(d) any incidents of disorder

(e) seizures of drugs or offensive weapons

(f) any faults in the CCTV system

(g) any visit by a relevant authority or emergency service.

The incident record shall be kept on the premises and be available for inspection by the Police or authorised officers of the Licensing Authority at all times the premises is open.

10. All plant, machinery and any sound insulation equipment shall be correctly installed, operated, maintained and regularly serviced, all in accordance with the manufacturer's instructions, to ensure that it is operating correctly and efficiently so as not to cause a noise nuisance to neighbours.

11. A drugs policy shall be in effect and all staff shall be trained in the implementation of the policy. The policy should be made available to the Police or authorised officers of the Licensing Authority upon request.

LB1

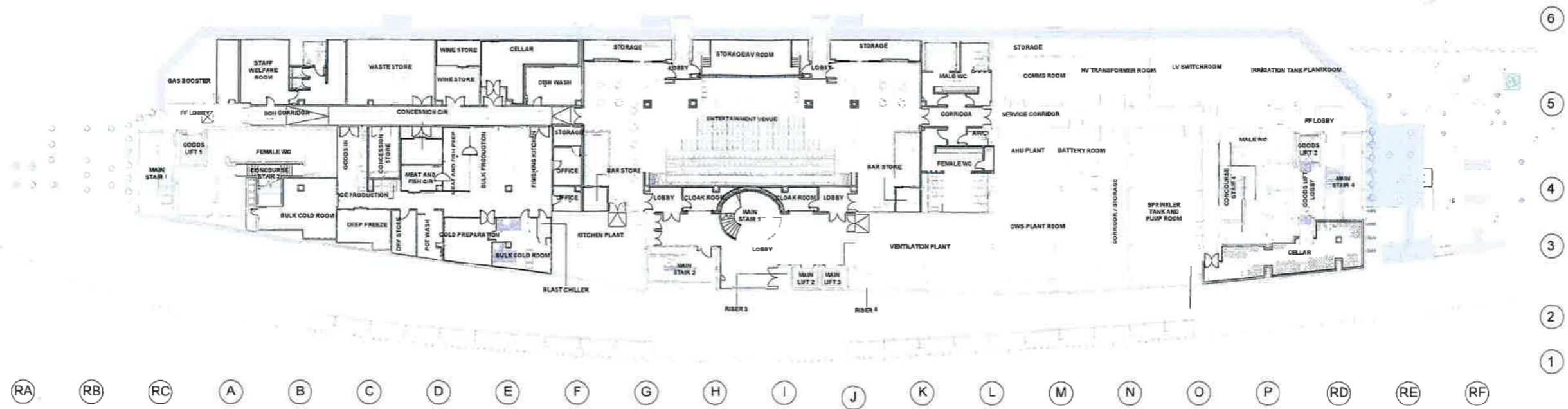

GROUND FLOOR

L00

